

Cambridge Waste Water Treatment Plant Relocation Project  
Anglian Water Services Limited

# Hedgerow Regulations and Tree Preservation Order Plans

Application Document Reference: 4.8  
PINS Project Reference: WW010003  
APFP Regulation No. 5(2)o

<b>Document title</b>	Hedgerow Regulations and Tree Preservation Plans
<b>Version No.</b>	C02
<b>Date Approved</b>	28.01.23
<b>Date 1<sup>st</sup> Issued</b>	30.01.23

## Version History

<b>Version</b>	<b>Date</b>	<b>Author</b>	<b>Description of change</b>
C01	30.01.23	-	DCO Submission
C02	13.10.23	-	Key Plan and Sheet 10 updated to reflect changes to the Scheme Order Limits



## Contents

<b>1</b>	<b>Introduction .....</b>	<b>1</b>
----------	---------------------------	----------

## Tables

	<b>Table 1-1: Schedule of plans in this application document.....</b>	<b>1</b>
--	---	----------

# 1 Introduction

- 1.1.1 The Hedgerow Regulations and Tree Preservation Plans (the Plans), listed in Table 1.1, relate to an application made by Anglian Water Services Limited (the “Applicant”) under section 37 of the Planning Act 2008 (the “2008 Act”) for a Development Consent Order (DCO) for the Cambridge Waste Water Treatment Plant Relocation Project.
- 1.1.2 The Plans are included in the DCO application in compliance with Regulations 5(2)(l) and 5(2)(o) of the Infrastructure Planning (Applications: Prescribed Forms and Procedure) Regulations 2009 (the “2009 Regulations”), which require:
  - “5(2) The application must be accompanied by—*
  - (l) where applicable, a plan with accompanying information identifying—*
  - (ii) habitats of protected species, important habitats or other diversity features;*
  - (o) “any other plans, drawings and sections necessary to describe the proposals for which development consent is sought, showing details of design, external appearance, and the preferred layout of buildings or structures, drainage, surface water management, means of vehicular and pedestrian access, any car parking to be provided, and means of landscaping;”*
- 1.1.3 For ease of cross referencing, the drawing sheets been provided with the same sheet layout, including Inset Plans and even where a particular sheet might not be relevant to a set of plans, for the following application documents: General Arrangement Plans (Application Document Reference 4.2), Works Plans (Application Document Reference 4.3), Rights of Way Plans (Application Document Reference 4.6), Access & Traffic Regulation Order Plans (Application Document Reference 4.7), and Hedgerow and Tree Preservation Order Plans (Application Document Reference 4.8).
- 1.1.4 As these Plans are part of the application documentation, they should be read alongside and are informed by the other application documentation. In particular, these Plans should be read alongside Schedule 15 (Removal of Hedgerows) of the Draft Development Consent Order (Application Document Reference 2.1) and the Works Plans (Application Document Reference 4.3).

**Table 1-1: Schedule of plans in this application document**

Application Document Ref	Document Title	Drawing Number	Revision	Status
4.8.0	4.8.0 Hedgerow Regulations and Tree Preservation Plans - Key Plan	00001-100006-CAMEST-ZZZ-LAY-Z-9820	CO2	S4

Application Document Ref	Document Title	Drawing Number	Revision	Status
4.8.1	4.8.1 Hedgerow Regulations and Tree Preservation Plans – Sheet 1	00001-100006-CAMEST-ZZZ-LAY-Z-9021	CO1	S4
4.8.2	4.8.2 Hedgerow Regulations and Tree Preservation Plans – Sheet 2	00001-100006-CAMEST-ZZZ-LAY-Z-9022	CO1	S4
4.8.3	4.8.3 Hedgerow Regulations and Tree Preservation Plans – Sheet 3	00001-100006-CAMEST-ZZZ-LAY-Z-9023	CO1	S4
4.8.4	4.8.4 Hedgerow Regulations and Tree Preservation Plans – Sheet 4	00001-100006-CAMEST-ZZZ-LAY-Z-9024	CO1	S4
4.8.5	4.8.5 Hedgerow Regulations and Tree Preservation Plans – Sheet 5	00001-100006-CAMEST-ZZZ-LAY-Z-9025	CO1	S4
4.8.6	4.8.6 Hedgerow Regulations and Tree Preservation Plans – Sheet 6	00001-100006-CAMEST-ZZZ-LAY-Z-9026	CO1	S4
4.8.7	4.8.7 Hedgerow Regulations and Tree Preservation Plans – Sheet 7	00001-100006-CAMEST-ZZZ-LAY-Z-9027	CO1	S4
4.8.8	4.8.8 Hedgerow Regulations and Tree Preservation Plans – Sheet 8	00001-100006-CAMEST-ZZZ-LAY-Z-9028	CO1	S4
4.8.9	4.8.9 Hedgerow Regulations and Tree Preservation Plans – Sheet 9	00001-100006-CAMEST-ZZZ-LAY-Z-9029	CO1	S4
4.8.10	4.8.10 Hedgerow Regulations and Tree Preservation Plans – Sheet 10	00001-100006-CAMEST-ZZZ-LAY-Z-9030	CO2	S4



LEGEND

- SCHEME ORDER LIMITS
- LAND OUTSIDE SCHEME ORDER LIMITS

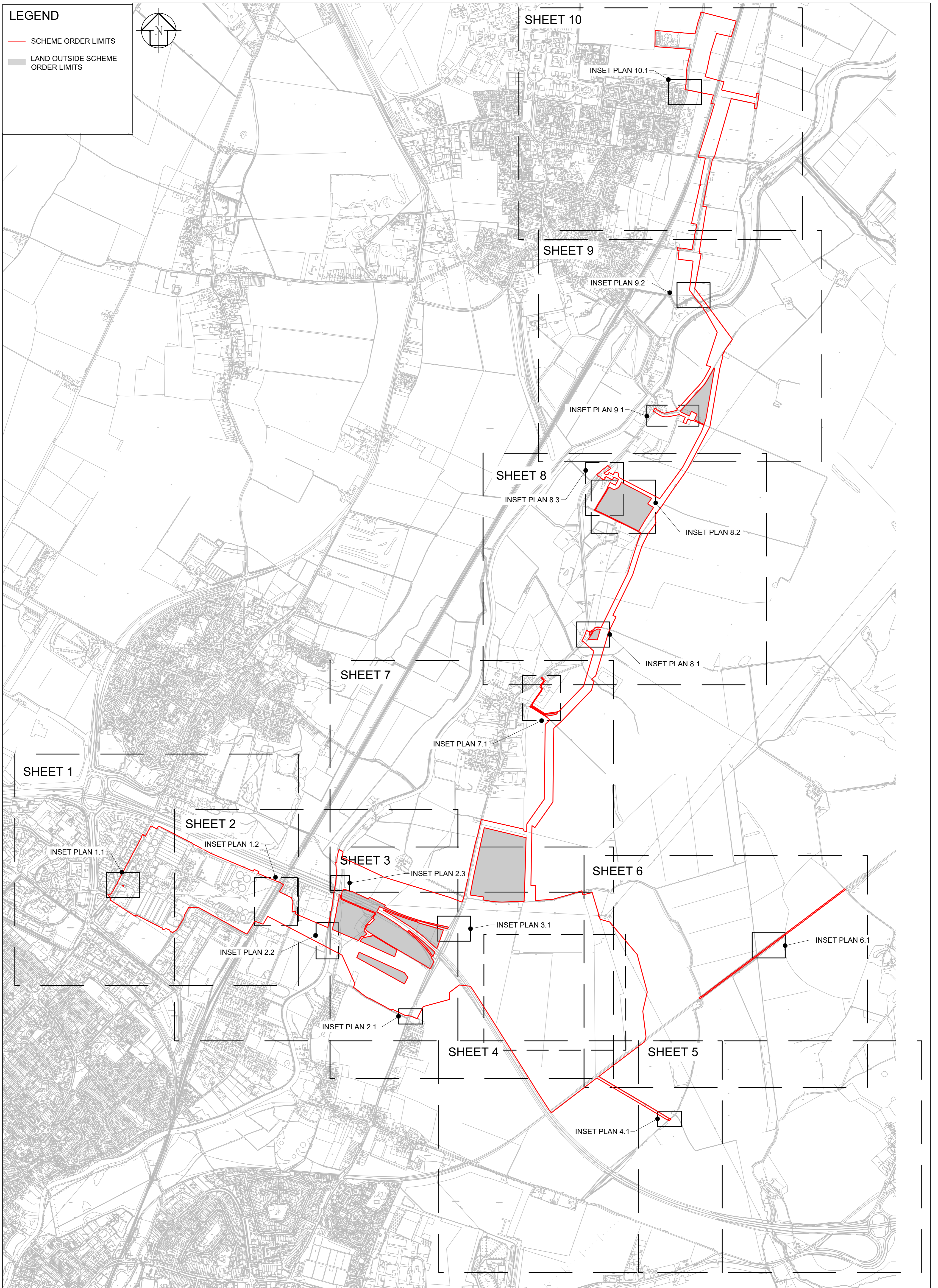

C02	29/09/23	FOR DCO SUBMISSION	S4	JL	AH	MR	DES'D: -	DATE: 29/09/23	DRAWN: JL	DATE: 29/09/23	CHK'D: AH	DATE: 29/09/23	APP'D: MR	DATE: 29/09/23	SCALE: 1:10000	@ A1	SCALE 1:10,000	0m 100m 200m 300m 400m 500m																			
REV		DATE		DETAILS		STAT		BY		CHK		APP		DES'D		DATE		DRAWN		DATE		CHK'D		DATE		APP'D		DATE		SCALE		@		SCALE		DRAWING SIZE	
<p><b>CAMBRIDGE WASTE WATER TREATMENT PLANT RELOCATION PROJECT</b></p>																		<p><b>4.8.0 HEDGEROW REGULATIONS &amp; TREE PRESERVATION PLANS - KEY PLAN REGULATION 5(2)(I)(ii) &amp; 5(2)(o)</b></p>				<p>Anglian Water Services Ltd, Lancaster House, Lancaster Way, Ermine Business Park, Huntingdon, PE29 6XU</p>				<p>The plan is produced by Anglian Water Services Limited, from Ordnance Survey Crown Copyright, Licence 100022432. This map is to be used for the purposes of viewing the location of Anglian Water plant only. Any other use of the map data or further copies are not permitted. This notice is not intended to exclude or restrict liability for death or personal injury resulting from negligence.</p> <p>The original document stored in the BIM 360 Doc Project carry the version, suitability code, revision and approval information. Prints are uncontrolled and shall not be used for construction.</p>										A1	
<p>PROJECT TITLE</p>																		<p>DRAWING TITLE</p>				<p>DRAWING No.</p>				<p>00001-100006-CAMEST-ZZZ-LAY-Z-9820</p>										<p>REV. STAT.</p>	
<p>CAMBRIDGE WASTE WATER TREATMENT PLANT RELOCATION PROJECT</p>																		<p>4.8.0 HEDGEROW REGULATIONS &amp; TREE PRESERVATION PLANS - KEY PLAN REGULATION 5(2)(I)(ii) &amp; 5(2)(o)</p>				<p>00001-100006-CAMEST-ZZZ-LAY-Z-9820</p>				<p>C02 S4</p>											



GENERAL NOTES

1. THESE PLANS SHOULD BE READ IN CONJUNCTION WITH SCHEDULE 15 (REMOVAL OF HEDGEROWS) TO THE DRAFT DEVELOPMENT CONSENT ORDER (APPLICATION DOCUMENT REFERENCE: 2.1) AND THE WORKS PLANS (APPLICATION DOCUMENT REFERENCE: 4.3)
2. THE LEGEND IS IDENTICAL ON ALL SHEETS OF THE HEDGEROW PLANS AND THEREFORE NOT ALL ITEMS DETAILED IN THE LEGEND ARE REPRESENTED ON EACH SHEET.

LEGEND

- SCHEME ORDER LIMITS
- LAND OUTSIDE ORDER LIMITS
- HEDGEROW RETAINED
- HEDGEROW REMOVED
- IMPORTANT HEDGEROW RETAINED
- IMPORTANT HEDGEROW REMOVED
- CONSERVATION AREA BAITS BITE LOCK
- CONSERVATION AREA FEN DITTON
- INDIVIDUAL TREE REMOVED
- H#** START & END POINT OF HEDGEROW TO BE REMOVED

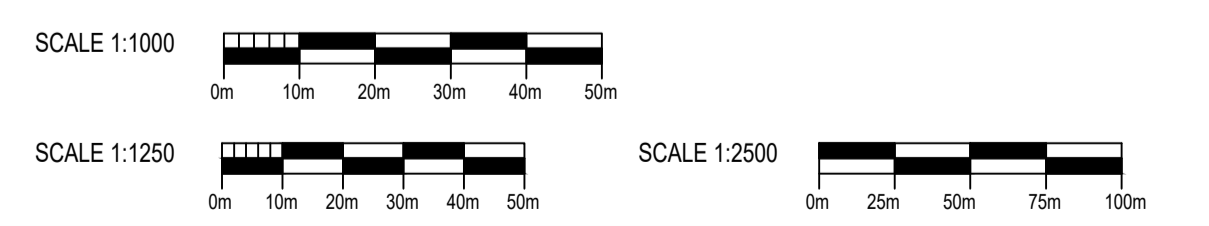
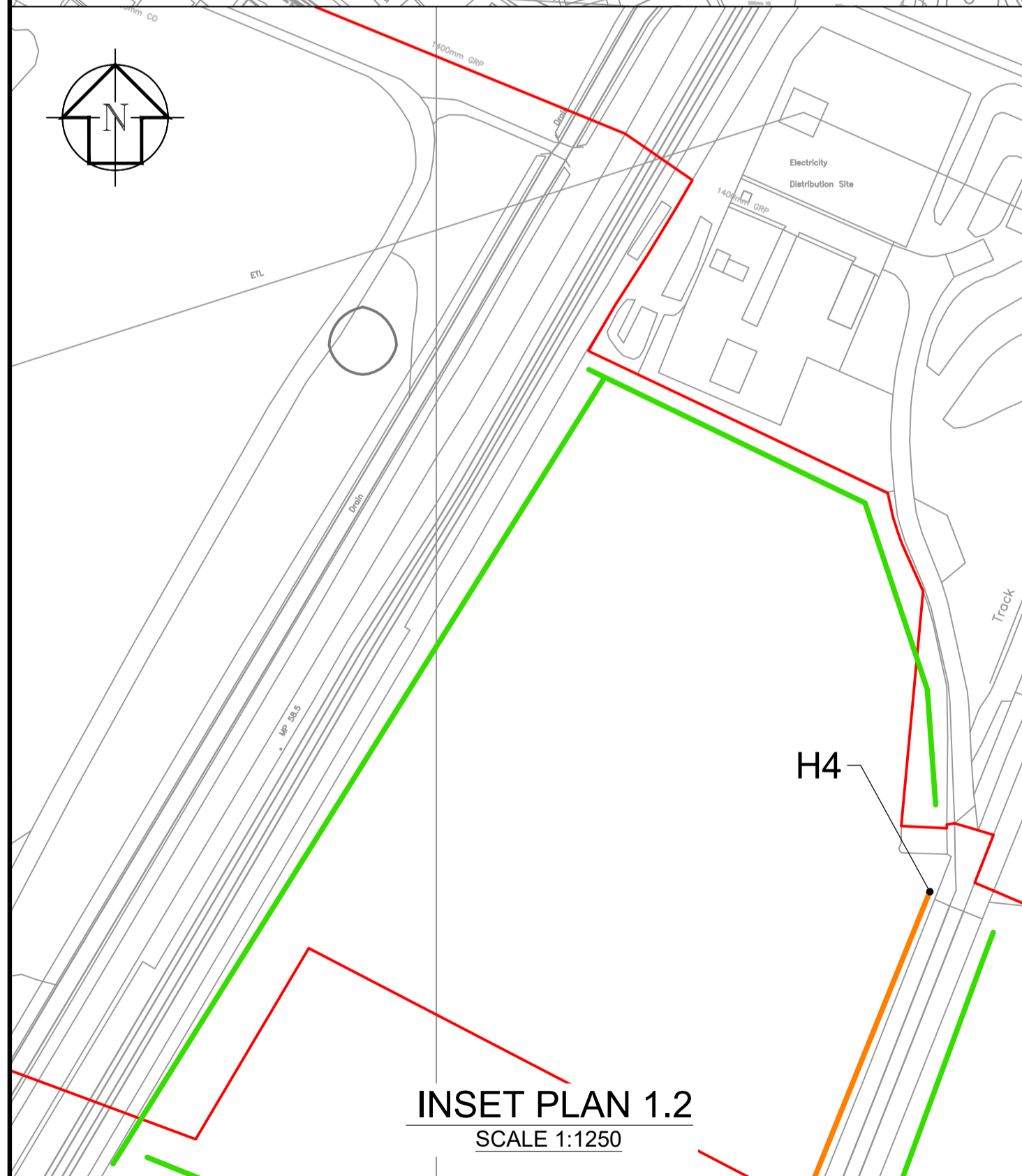
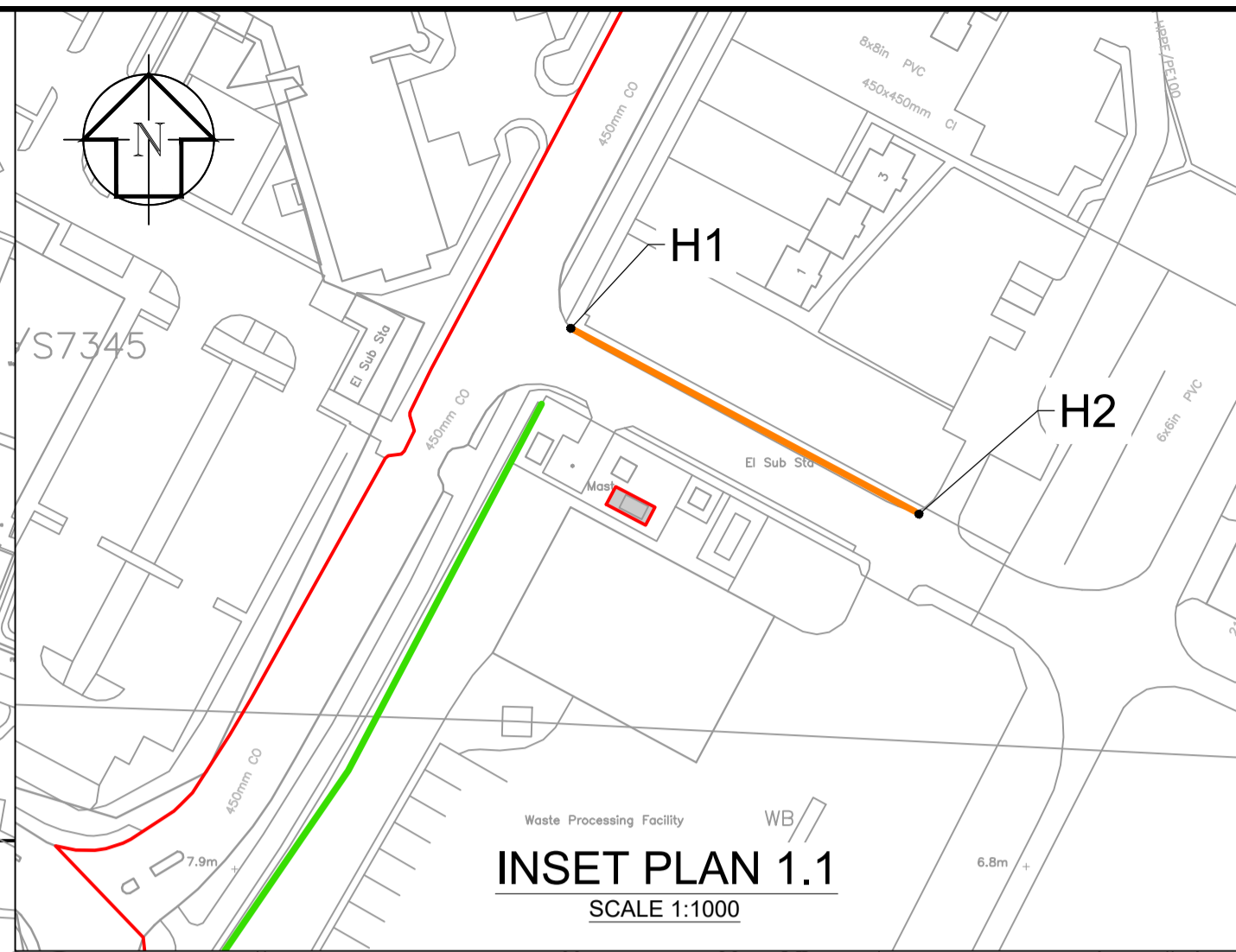
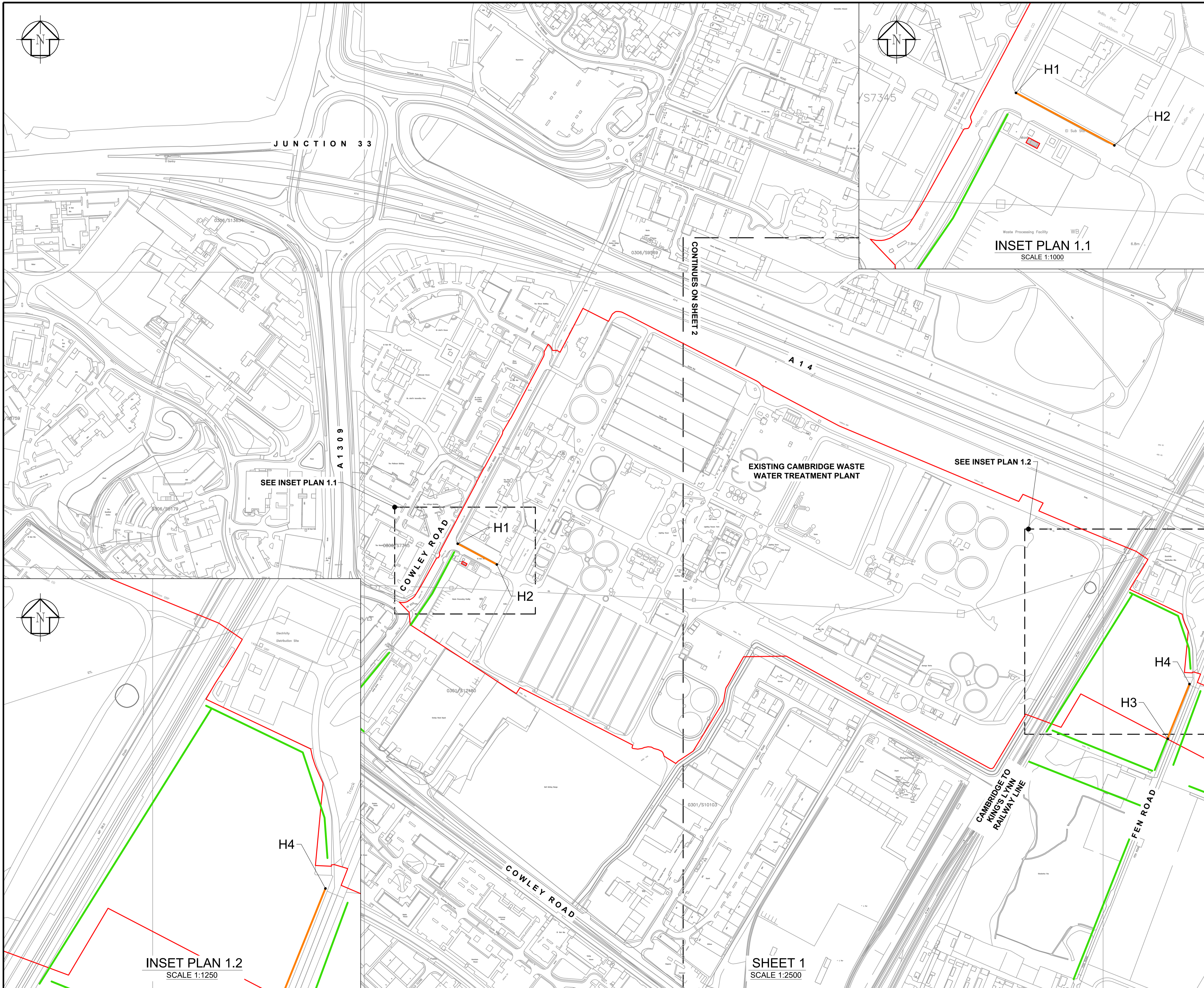

DES'D: -	DATE: 20/01/23	SCALE: AS SHOWN @A1
DRAWN: JL	DATE: 20/01/23	
CHK'D: MR	DATE: 20/01/23	
APP'D: MH	DATE: 20/01/23	
C01 20/01/23 FOR DCO SUBMISSION	S4 JL MR MH	
REV DATE DETAILS	STAT BY CHK APP	

PROJECT TITLE  
**CAMBRIDGE WASTE WATER TREATMENT PLANT RELOCATION PROJECT**

DRAWING TITLE  
**4.8.1 HEDGEROW REGULATIONS AND TREE PRESERVATION PLANS SHEET 1**  
 REGULATION 5(2)(I)(ii) & 5(2)(o)



The plan is produced by Anghian Water Services Limited, from Ordnance Survey Crown Copyright, Licence 100022432. This map is to be used for the purposes of viewing the location of Anghian Water plant only. Any other use of the map data or further copies are not permitted. This notice is not intended to exclude or restrict liability for death or personal injury resulting from negligence. The original document stored in the BIM 360 Doc Project carry the version, suitability code, revision and approval information. Prints are uncontrolled and shall not be used for construction.

DRAWING No. **00001-100006-CAMEST-ZZZ-LAY-Z-9021**

REV. STAT. **A1**  
**C01 S4**







GENERAL NOTES

1. THESE PLANS SHOULD BE READ IN CONJUNCTION WITH SCHEDULE 15 (REMOVAL OF HEDGEROWS) TO THE DRAFT DEVELOPMENT CONSENT ORDER (APPLICATION DOCUMENT REFERENCE: 2.1) AND THE WORKS PLANS (APPLICATION DOCUMENT REFERENCE: 4.3)
2. THE LEGEND IS IDENTICAL ON ALL SHEETS OF THE HEDGEROW PLANS AND THEREFORE NOT ALL ITEMS DETAILED IN THE LEGEND ARE REPRESENTED ON EACH SHEET.

LEGEND

- SCHEME ORDER LIMITS
- LAND OUTSIDE ORDER LIMITS
- HEDGEROW RETAINED
- HEDGEROW REMOVED
- IMPORTANT HEDGEROW RETAINED
- IMPORTANT HEDGEROW REMOVED
- CONSERVATION AREA BAITS BITE LOCK
- CONSERVATION AREA FEN DITTON
- o INDIVIDUAL TREE REMOVED
- H#** START & END POINT OF HEDGEROW TO BE REMOVED

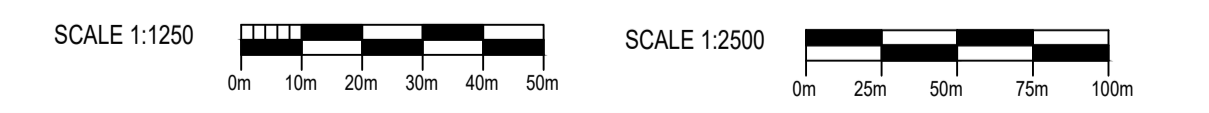
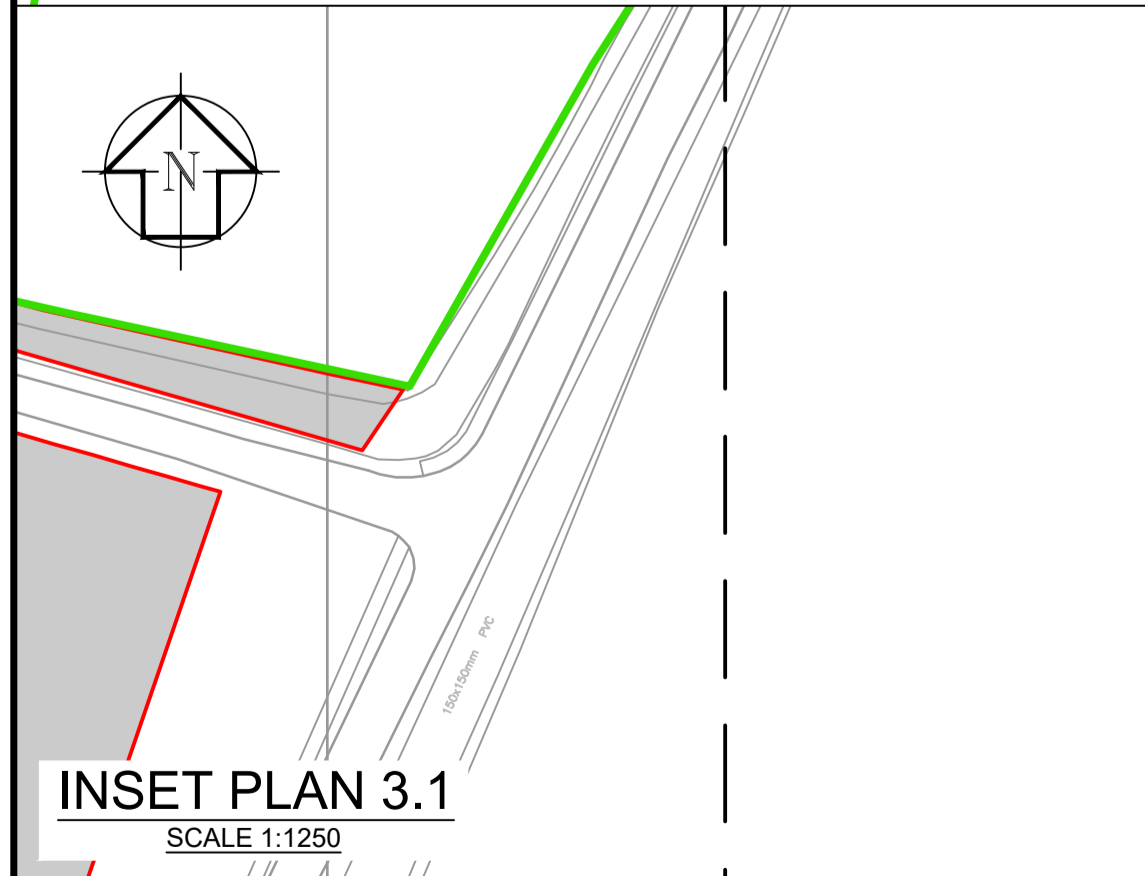
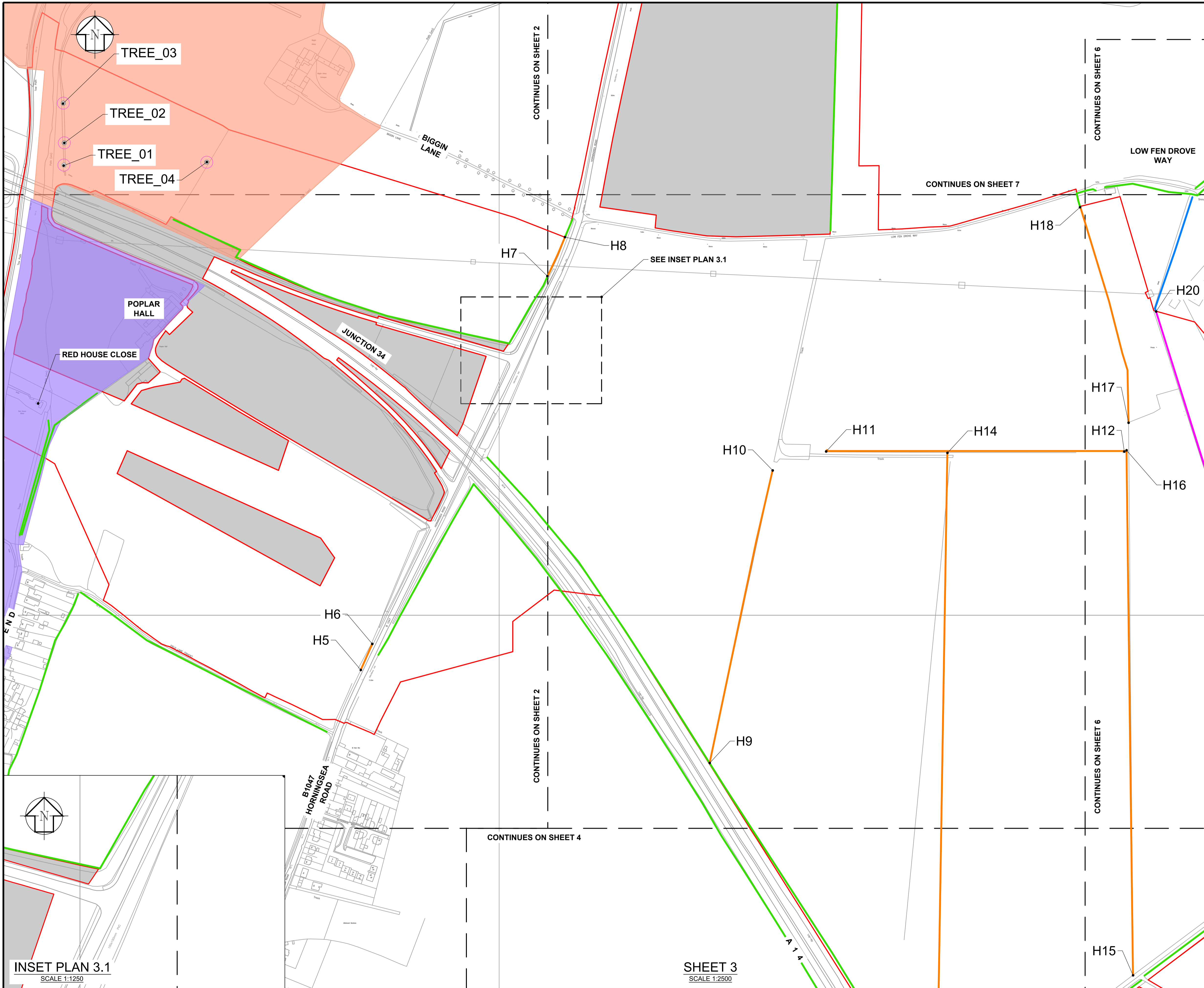

DES'D: -	DATE: 20/01/23	SCALE: AS SHOWN @A1
DRAWN: JL	DATE: 20/01/23	
CHK'D: MR	DATE: 20/01/23	
APP'D: MH	DATE: 20/01/23	
C01 20/01/23 FOR DCO SUBMISSION	S4 JL MR MH	
REV DATE DETAILS	STAT BY CHK APP	

PROJECT TITLE  
**CAMBRIDGE WASTE WATER TREATMENT PLANT RELOCATION PROJECT**

DRAWING TITLE  
**4.8.3 HEDGEROW REGULATIONS AND TREE PRESERVATION PLANS SHEET 3 REGULATION 5(2)(I)(ii) & 5(2)(o)**



The plan is produced by Anglian Water Services Limited, from Ordnance Survey Crown Copyright, Licence 100022432. This map is to be used for the purposes of viewing the location of Anglian Water plant only. Any other use of the map data or further copies are not permitted. This notice is not intended to exclude or restrict liability for death or personal injury resulting from negligence. The original document stored in the BIM 360 Doc Project carry the version, suitability code, revision and approval information. Prints are uncontrolled and shall not be used for construction.

DRAWING No. **00001-100006-CAMEST-ZZZ-LAY-Z-9023**

REV. STAT. **A1**  
**C01 S4**



GENERAL NOTES

1. THESE PLANS SHOULD BE READ IN CONJUNCTION WITH SCHEDULE 15 (REMOVAL OF HEDGEROWS) TO THE DRAFT DEVELOPMENT CONSENT ORDER (APPLICATION DOCUMENT REFERENCE: 2.1) AND THE WORKS PLANS (APPLICATION DOCUMENT REFERENCE: 4.3)
2. THE LEGEND IS IDENTICAL ON ALL SHEETS OF THE HEDGEROW PLANS AND THEREFORE NOT ALL ITEMS DETAILED IN THE LEGEND ARE REPRESENTED ON EACH SHEET.

LEGEND

- SCHEME ORDER LIMITS
- LAND OUTSIDE ORDER LIMITS
- HEDGEROW RETAINED
- HEDGEROW REMOVED
- IMPORTANT HEDGEROW RETAINED
- IMPORTANT HEDGEROW REMOVED
- CONSERVATION AREA BAITS BITE LOCK
- CONSERVATION AREA FEN DITTON
- INDIVIDUAL TREE REMOVED
- H#** START & END POINT OF HEDGEROW TO BE REMOVED

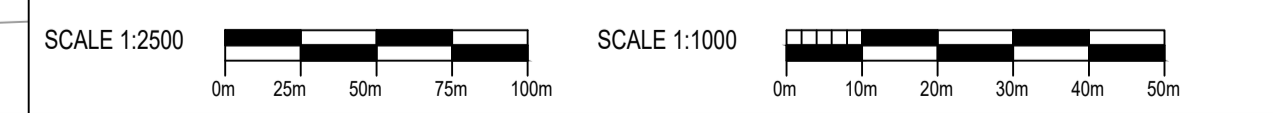
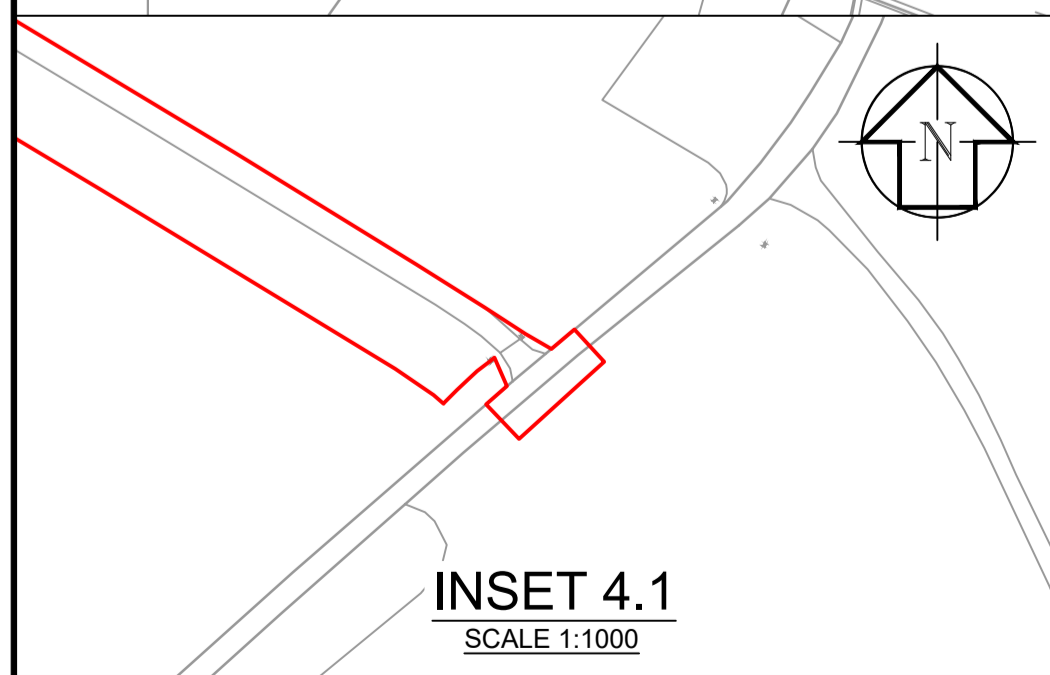
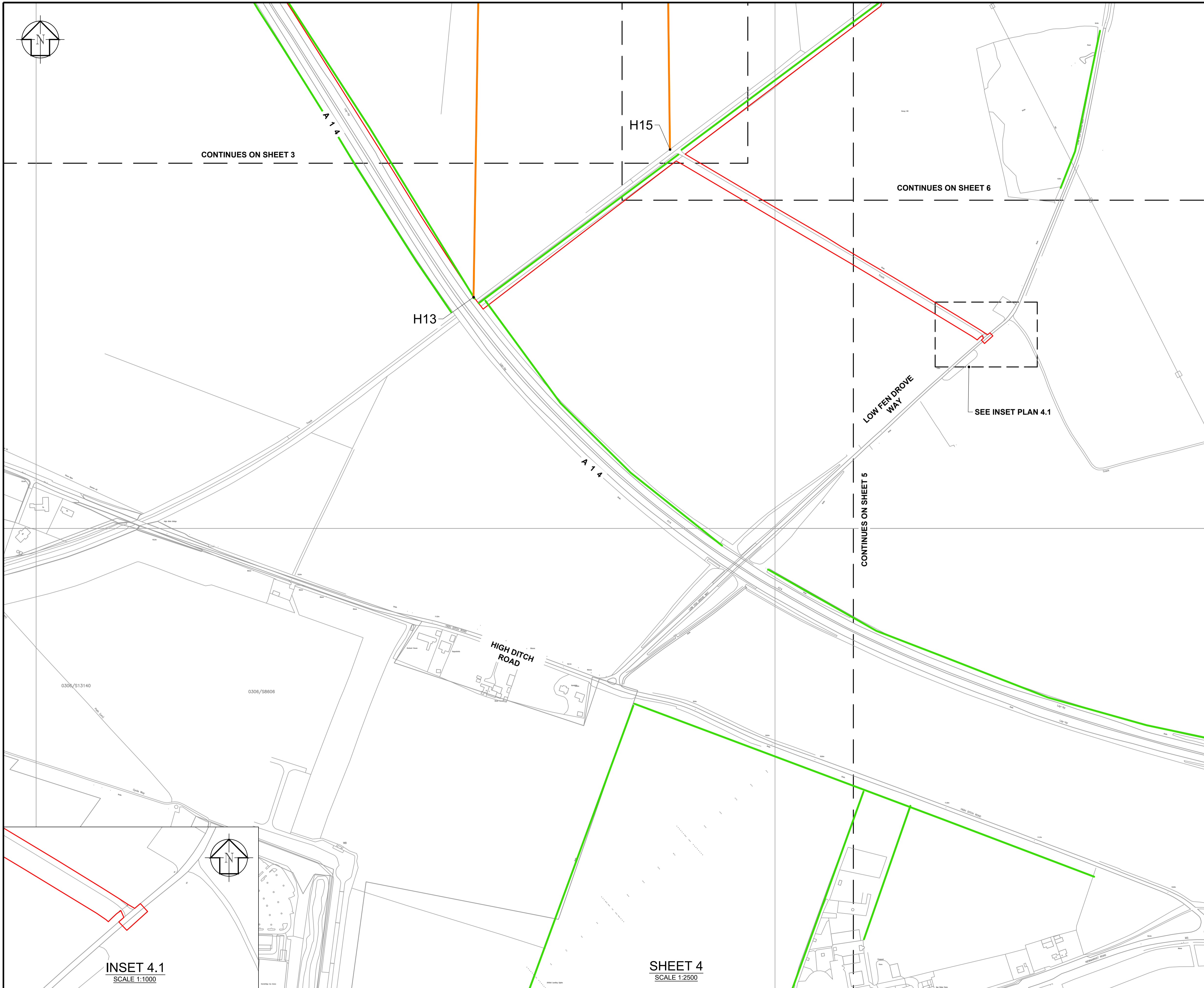

DES'D: -	DATE: 20/01/23	SCALE: AS SHOWN @A1
DRAWN: JL	DATE: 20/01/23	
CHK'D: MR	DATE: 20/01/23	
APP'D: MH	DATE: 20/01/23	
C01	20/01/23	FOR DCO SUBMISSION
REV	DATE	DETAILS
S4	JL	MR
STAT	BY	CHK
MH	APP	

PROJECT TITLE  
**CAMBRIDGE WASTE WATER TREATMENT PLANT RELOCATION PROJECT**

DRAWING TITLE  
**4.8.4 HEDGEROW REGULATIONS AND TREE PRESERVATION PLANS SHEET 4**  
REGULATION 5(2)(I)(ii) & 5(2)(o)

**anglianwater**  
Anglian Water Services Ltd, Lancaster House, Lancaster Way, Ermine Business Park, Huntingdon, PE29 6XU  
Tel: [REDACTED]

The plan is produced by Anglian Water Services Limited, from Ordnance Survey Crown Copyright, Licence 100022432. This map is to be used for the purposes of viewing the location of Anglian Water plant only. Any other use of the map data or further copies are not permitted. This notice is not intended to exclude or restrict liability for death or personal injury resulting from negligence. The original document stored in the BIM 360 Doc Project carry the version, suitability code, revision and approval information. Prints are uncontrolled and shall not be used for construction.

DRAWING No. **00001-100006-CAMEST-ZZZ-LAY-Z-9024**

REV.	STAT.
C01	S4



GENERAL NOTES

1. THESE PLANS SHOULD BE READ IN CONJUNCTION WITH SCHEDULE 15 (REMOVAL OF HEDGEROWS) TO THE DRAFT DEVELOPMENT CONSENT ORDER (APPLICATION DOCUMENT REFERENCE: 2.1) AND THE WORKS PLANS (APPLICATION DOCUMENT REFERENCE: 4.3)
2. THE LEGEND IS IDENTICAL ON ALL SHEETS OF THE HEDGEROW PLANS AND THEREFORE NOT ALL ITEMS DETAILED IN THE LEGEND ARE REPRESENTED ON EACH SHEET.

LEGEND

- SCHEME ORDER LIMITS
- LAND OUTSIDE ORDER LIMITS
- HEDGEROW RETAINED
- HEDGEROW REMOVED
- IMPORTANT HEDGEROW RETAINED
- IMPORTANT HEDGEROW REMOVED
- CONSERVATION AREA BAITS BITE LOCK
- CONSERVATION AREA FEN DITTON
- INDIVIDUAL TREE REMOVED
- H#** START & END POINT OF HEDGEROW TO BE REMOVED

**NO HEDGEROWS  
AFFECTED HERE  
DRAWING INCLUDED FOR  
COMPLETENESS**

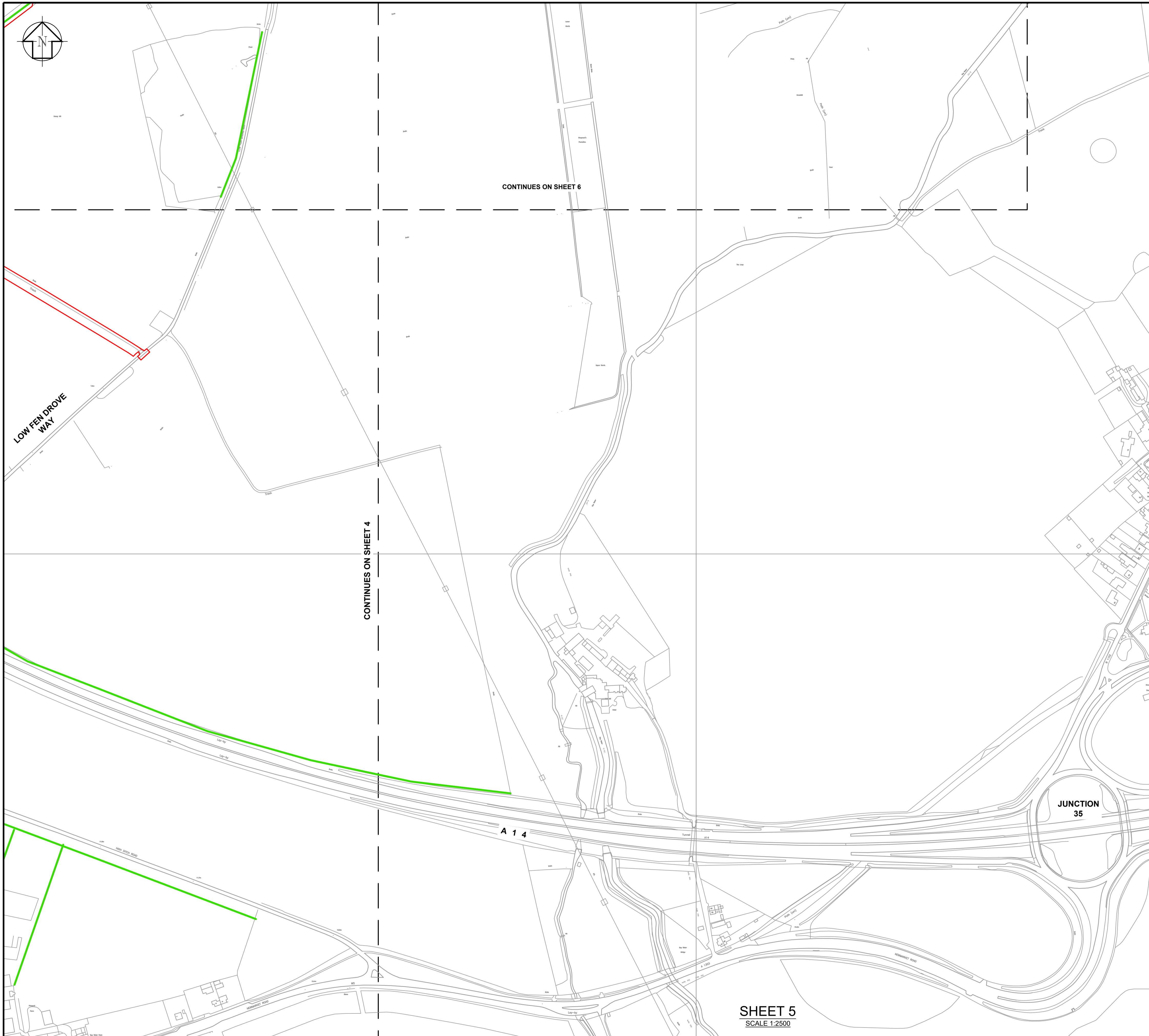
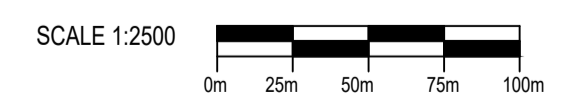

END OF OS TILE

DES'D: -	DATE: 20/01/23	SCALE: AS SHOWN @A1
DRAWN: JL	DATE: 20/01/23	
CHK'D: MR	DATE: 20/01/23	
APP'D: MH	DATE: 20/01/23	
C01 20/01/23 FOR DCO SUBMISSION	S4 JL MR MH	
REV DATE DETAILS	STAT BY CHK APP	

PROJECT TITLE	CAMBRIDGE WASTE WATER TREATMENT PLANT RELOCATION PROJECT
DRAWING TITLE	4.8.5 HEDGEROW REGULATIONS AND TREE PRESERVATION PLANS SHEET 5 REGULATION 5(2)(I)(ii) & 5(2)(o)

anlianwater  
 Anlian Water Services Ltd, Lancaster House,  
 Lancaster Way, Ermine Business Park, Huntingdon,  
 PE29 6XU

The plan is produced by Anlian Water Services Limited, from Ordnance Survey Crown Copyright, Licence 100022432. This map is to be used for the purposes of viewing the location of Anlian Water plant only. Any other use of the map data or further copies are not permitted. This notice is not intended to exclude or restrict liability for death or personal injury resulting from negligence. The original document stored in the BIM 360 Doc Project carry the version, suitability code, revision and approval information. Prints are uncontrolled and shall not be used for construction.

DRAWING No. 00001-100006-CAMEST-ZZZ-LAY-Z-9025

REV. STAT.	C01 S4
DRAWING SIZE	A1







GENERAL NOTES

1. THESE PLANS SHOULD BE READ IN CONJUNCTION WITH SCHEDULE 15 (REMOVAL OF HEDGEROWS) TO THE DRAFT DEVELOPMENT CONSENT ORDER (APPLICATION DOCUMENT REFERENCE: 2.1) AND THE WORKS PLANS (APPLICATION DOCUMENT REFERENCE: 4.3)
2. THE LEGEND IS IDENTICAL ON ALL SHEETS OF THE HEDGEROW PLANS AND THEREFORE NOT ALL ITEMS DETAILED IN THE LEGEND ARE REPRESENTED ON EACH SHEET.

LEGEND

- SCHEME ORDER LIMITS
- LAND OUTSIDE ORDER LIMITS
- HEDGEROW RETAINED
- HEDGEROW REMOVED
- IMPORTANT HEDGEROW RETAINED
- IMPORTANT HEDGEROW REMOVED
- CONSERVATION AREA BAITS BITE LOCK
- CONSERVATION AREA FEN DITTON
- INDIVIDUAL TREE REMOVED
- H#** START & END POINT OF HEDGEROW TO BE REMOVED

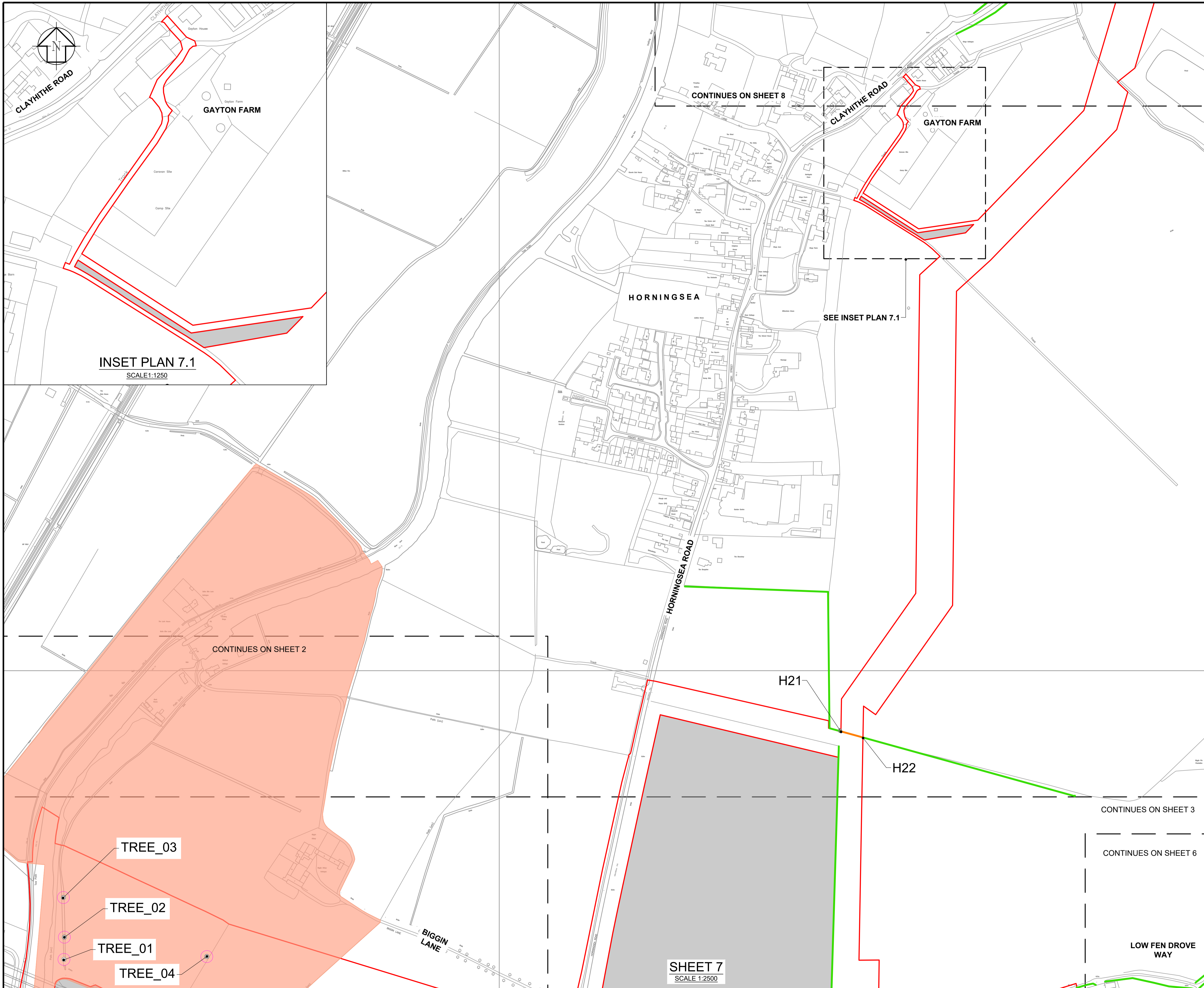

**INSET PLAN 7.1**  
SCALE 1:1250

**SHEET 7**  
SCALE 1:2500

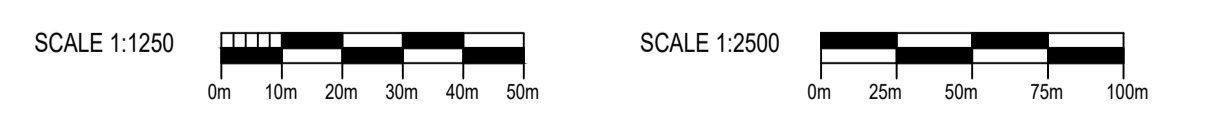

DES'D: -	DATE: 20/01/23	SCALE: AS SHOWN @A1
DRAWN: JL	DATE: 20/01/23	
CHK'D: MR	DATE: 20/01/23	
APP'D: MH	DATE: 20/01/23	
C01 20/01/23 FOR DCO SUBMISSION	S4 JL MR MH	
REV DATE DETAILS	STAT BY CHK APP	

PROJECT TITLE  
**CAMBRIDGE WASTE WATER TREATMENT PLANT RELOCATION PROJECT**

DRAWING TITLE  
**4.8.7 HEDGEROW REGULATIONS AND TREE PRESERVATION PLANS SHEET 7 REGULATION 5(2)(I)(ii) & 5(2)(o)**



The plan is produced by Anglian Water Services Limited, from Ordnance Survey Crown Copyright, Licence 100022432. This map is to be used for the purposes of viewing the location of Anglian Water plant only. Any other use of the map data or further copies are not permitted. This notice is not intended to exclude or restrict liability for death or personal injury resulting from negligence. The original document stored in the BIM 360 Doc Project carry the version, suitability code, revision and approval information. Prints are uncontrolled and shall not be used for construction.

DRAWING No. **00001-100006-CAMEST-ZZZ-LAY-Z-9027**

REV. STAT. **A1**  
C01 S4



GENERAL NOTES

1. THESE PLANS SHOULD BE READ IN CONJUNCTION WITH SCHEDULE 15 (REMOVAL OF HEDGEROWS) TO THE DRAFT DEVELOPMENT CONSENT ORDER (APPLICATION DOCUMENT REFERENCE: 2.1) AND THE WORKS PLANS (APPLICATION DOCUMENT REFERENCE: 4.3)
2. THE LEGEND IS IDENTICAL ON ALL SHEETS OF THE HEDGEROW PLANS AND THEREFORE NOT ALL ITEMS DETAILED IN THE LEGEND ARE REPRESENTED ON EACH SHEET.

LEGEND

- SCHEME ORDER LIMITS
- LAND OUTSIDE ORDER LIMITS
- HEDGEROW RETAINED
- HEDGEROW REMOVED
- IMPORTANT HEDGEROW RETAINED
- IMPORTANT HEDGEROW REMOVED
- CONSERVATION AREA BAITS BITE LOCK
- CONSERVATION AREA FEN DITTON
- o INDIVIDUAL TREE REMOVED
- H#** START & END POINT OF HEDGEROW TO BE REMOVED

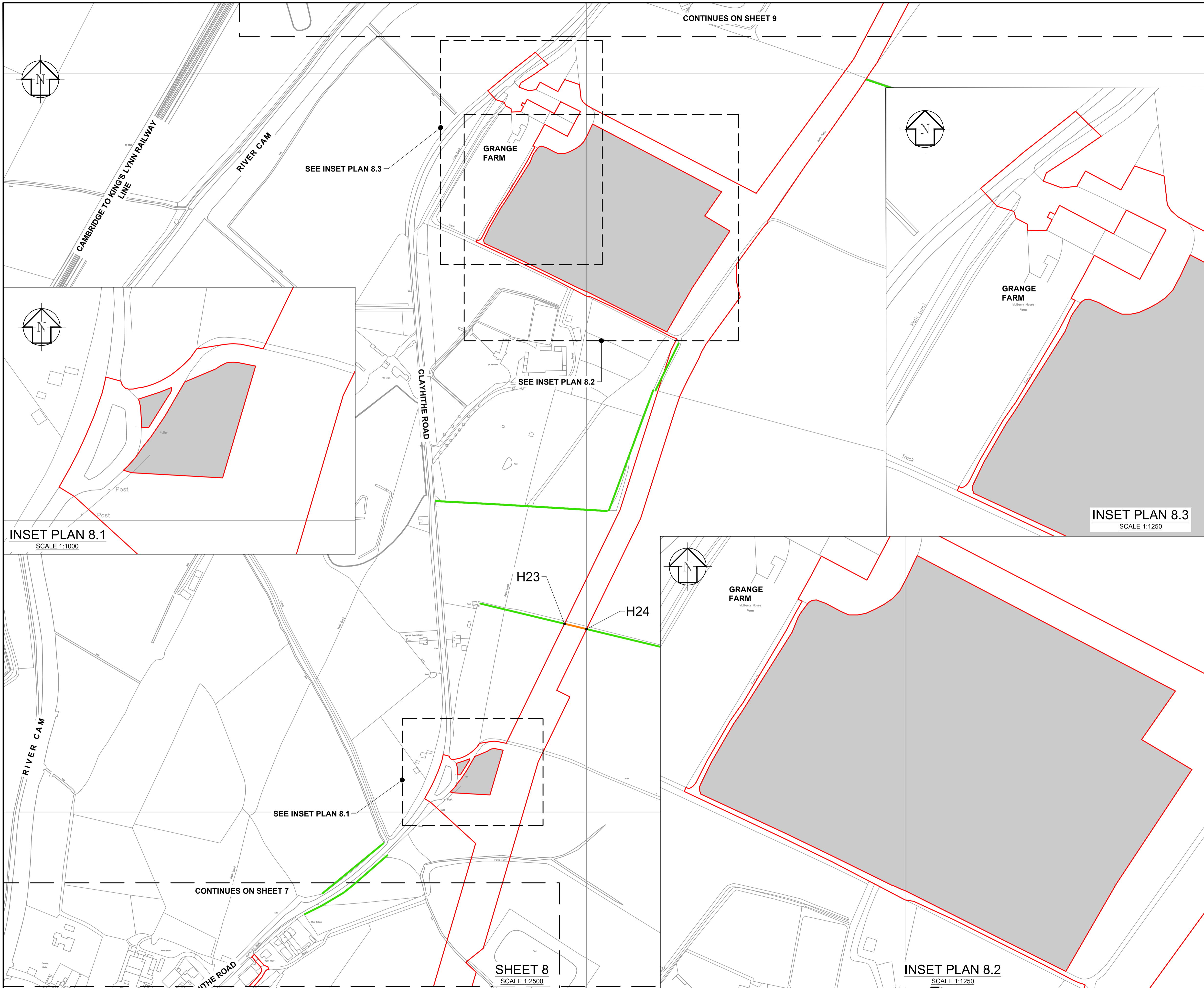

INSET PLAN 8.1  
SCALE 1:1000

INSET PLAN 8.3  
SCALE 1:1250

SHEET 8  
SCALE 1:2500

INSET PLAN 8.2  
SCALE 1:1250

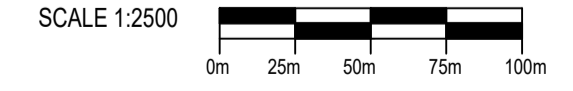
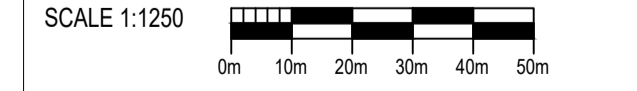
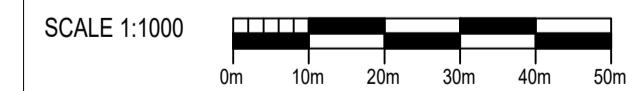

DES'D: -	DATE: 20/01/23	SCALE: AS SHOWN @A1
DRAWN: JL	DATE: 20/01/23	
CHK'D: MR	DATE: 20/01/23	
APP'D: MH	DATE: 20/01/23	
C01 20/01/23 FOR DCO SUBMISSION	S4 JL MR MH	
REV DATE DETAILS	STAT BY CHK APP	

PROJECT TITLE  
**CAMBRIDGE WASTE WATER TREATMENT PLANT RELOCATION PROJECT**

DRAWING TITLE  
**4.8.8 HEDGEROW REGULATIONS AND TREE PRESERVATION PLANS SHEET 8 REGULATION 5(2)(I)(ii) & 5(2)(o)**



The plan is produced by Anglian Water Services Limited, from Ordnance Survey Crown Copyright, Licence 100022432. This map is to be used for the purposes of viewing the location of Anglian Water plant only. Any other use of the map data or further copies are not permitted. This notice is not intended to exclude or restrict liability for death or personal injury resulting from negligence. The original document stored in the BIM 360 Doc Project carry the version, suitability code, revision and approval information. Prints are uncontrolled and shall not be used for construction.

DRAWING No. **00001-100006-CAMEST-ZZZ-LAY-Z-9028**

DRAWING SIZE: **A1**  
REV. STAT. **C01 S4**







GENERAL NOTES

1. THESE PLANS SHOULD BE READ IN CONJUNCTION WITH SCHEDULE 15 (REMOVAL OF HEDGEROWS) TO THE DRAFT DEVELOPMENT CONSENT ORDER (APPLICATION DOCUMENT REFERENCE: 2.1) AND THE WORKS PLANS (APPLICATION DOCUMENT REFERENCE: 4.3)
2. THE LEGEND IS IDENTICAL ON ALL SHEETS OF THE HEDGEROW PLANS AND THEREFORE NOT ALL ITEMS DETAILED IN THE LEGEND ARE REPRESENTED ON EACH SHEET.

LEGEND

- SCHEME ORDER LIMITS
- LAND OUTSIDE ORDER LIMITS
- HEDGEROW RETAINED
- HEDGEROW REMOVED
- IMPORTANT HEDGEROW RETAINED
- IMPORTANT HEDGEROW REMOVED
- CONSERVATION AREA BAITS BITE LOCK
- CONSERVATION AREA FEN DITTON
- INDIVIDUAL TREE REMOVED
- H#** START & END POINT OF HEDGEROW TO BE REMOVED

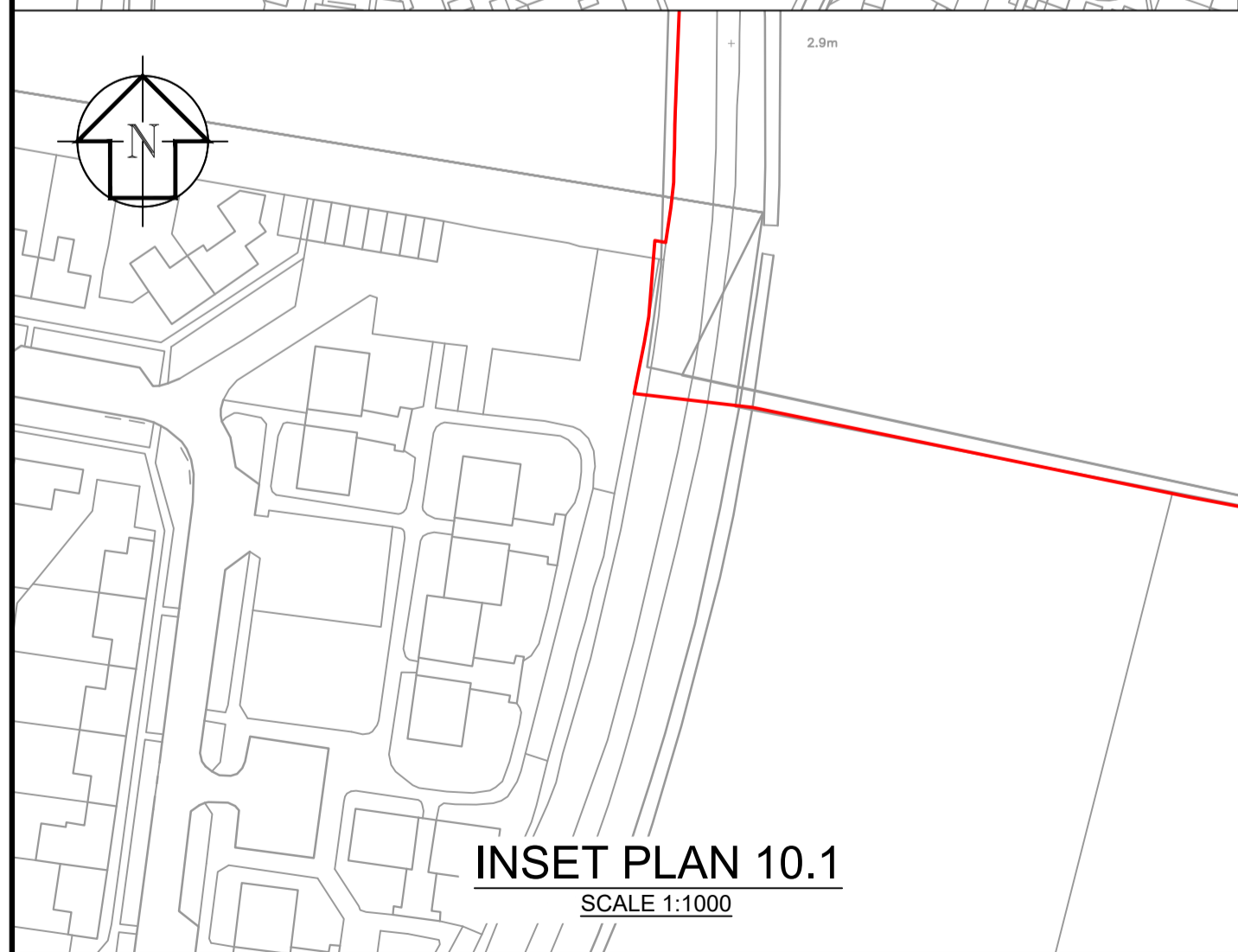
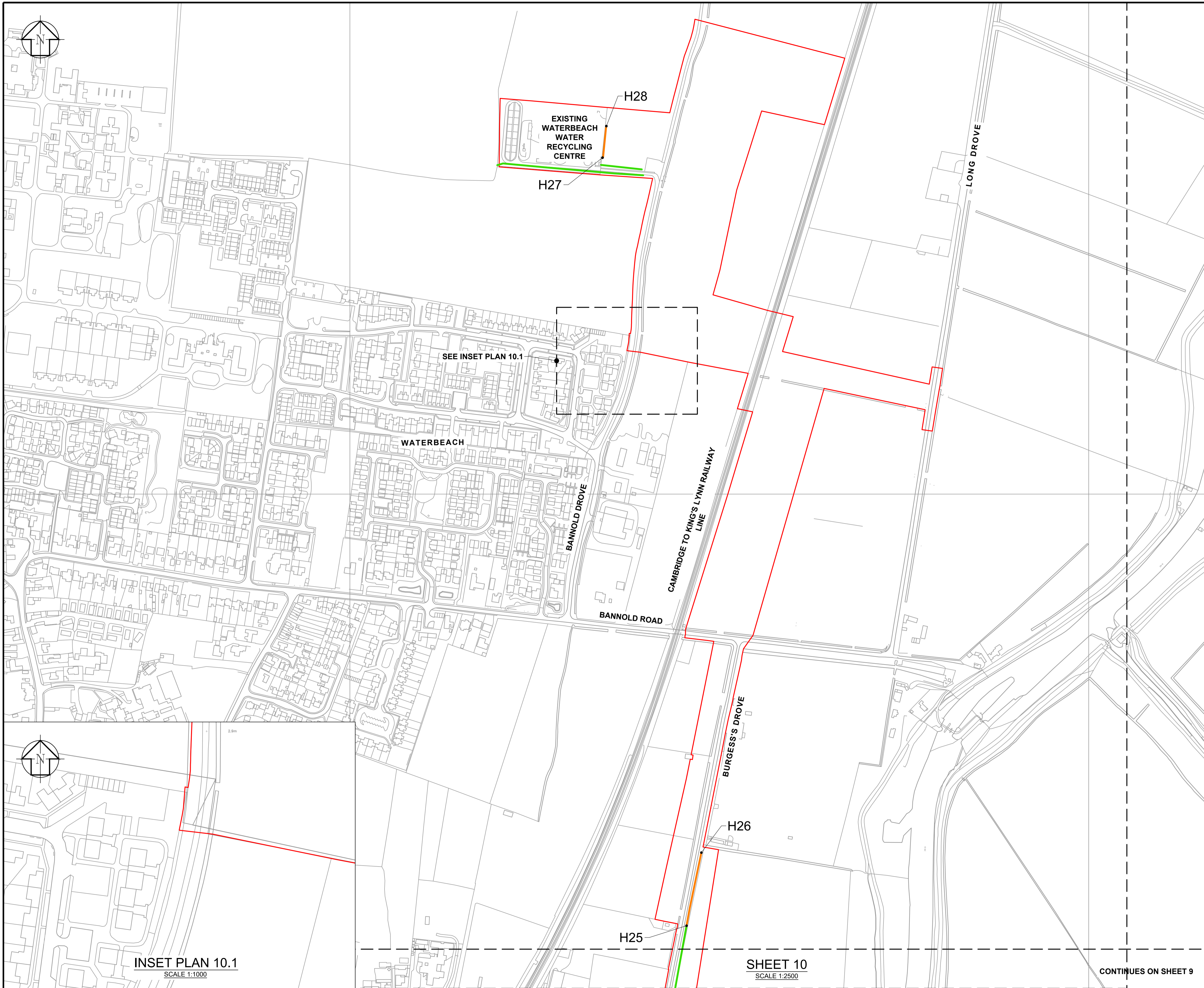

INSET PLAN 10.1  
SCALE 1:1000

SHEET 10  
SCALE 1:2500

CONTINUES ON SHEET 9

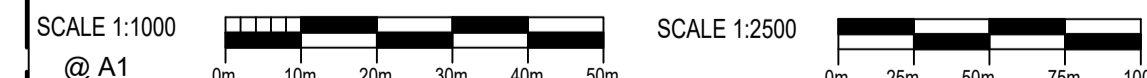

DES'D: -	DATE: 29/09/23	SCALE: AS SHOWN @A1	PROJECT TITLE	DRAWING TITLE		The plan is produced by Anglian Water Services Limited, from Ordnance Survey Crown Copyright, Licence 100022432. This map is to be used for the purposes of viewing the location of Anglian Water plant only. Any other use of the map data or further copies are not permitted. This notice is not intended to exclude or restrict liability for death or personal injury resulting from negligence. The original document stored in the BIM 360 Doc Project carry the version, suitability code, revision and approval information. Prints are uncontrolled and shall not be used for construction.	DRAWING No.	00001-100006-CAMEST-ZZZ-LAY-Z-9030	REV.	STAT.
DRAWN: JL	DATE: 29/09/23		CAMBRIDGE WASTE WATER TREATMENT PLANT RELOCATION PROJECT	4.8.10 HEDGEROW REGULATIONS AND TREE PRESERVATION PLANS SHEET 10 REGULATION 5(2)(I)(ii) & 5(2)(o)					C02	S4
C02 29/09/23	FOR REVISED DCO SUBMISSION	S4 SC AH MR	CHK'D: AH	DATE: 29/09/23						
C01 20/01/23	FOR DCO SUBMISSION	S4 JL MR MH	APP'D: MR	DATE: 29/09/23						
REV	DATE	DETAILS	STAT	BY	CHK	APP				

PROJECT TITLE  
**CAMBRIDGE WASTE WATER TREATMENT PLANT RELOCATION PROJECT**

DRAWING TITLE  
**4.8.10 HEDGEROW REGULATIONS AND TREE PRESERVATION PLANS SHEET 10 REGULATION 5(2)(I)(ii) & 5(2)(o)**

**anglianwater**

Anglian Water Services Ltd, Lancaster House, Lancaster Way, Ermine Business Park, Huntingdon, PE29 6XU  
Tel: [REDACTED]

DRAWING No.  
**00001-100006-CAMEST-ZZZ-LAY-Z-9030**

DRAWING SIZE:  
**A1**

REV. STAT.  
**C02 S4**



## Get in touch

You can contact us by:



Emailing at [info@cwwtpr.com](mailto:info@cwwtpr.com)



Calling our Freephone information line on **0808 196 1661**



Writing to us at **Freepost: CWWTPR**

You can view all our DCO application documents and updates on the application on The Planning Inspectorate website:

<https://infrastructure.planninginspectorate.gov.uk/projects/eastern/cambridge-waste-water-treatment-plant-relocation/>